



Eriswell Road, Brandon, IP27 9AF

Rent - £1,350 Per Month

Deposit - £1,557

This well-presented terraced home offers practical accommodation in a pleasant Lakenheath location, within easy reach of the nearby RAF bases. The ground floor includes an entrance hallway, a downstairs cloakroom, a comfortable lounge, useful understairs storage, and a kitchen/dining room with fitted units and space for appliances.

Upstairs there are two double bedrooms, both with built-in wardrobes, along with a family bathroom with shower over bath. Outside, the property has a small front garden, an enclosed rear garden with patio area, plus a garage

- TWO DOUBLE BEDROOMS
- GARAGE AND PARKING
- BUILT-IN WARDROBES
- ENCLOSED REAR GARDEN
- COUNCIL TAX BAND - B
- CLOSE TO RAF BASES
- OVERLOOKING CRICKET FIELD
- DOWNSTAIRS WC
- EPC RATING - D
- EARLY VIEWING ADVISED



Council Tax Band: B - EPC Rating: D 67

GROUND FLOOR
32.4 sq.m. (349 sq.ft.) approx.

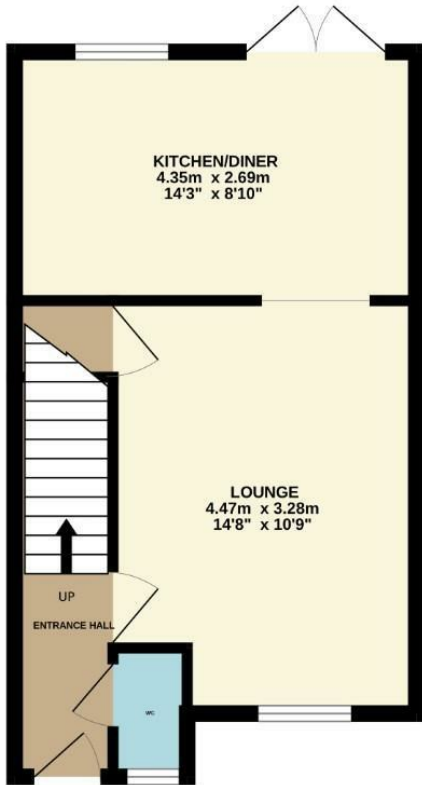

1ST FLOOR
25.9 sq.m. (279 sq.ft.) approx.

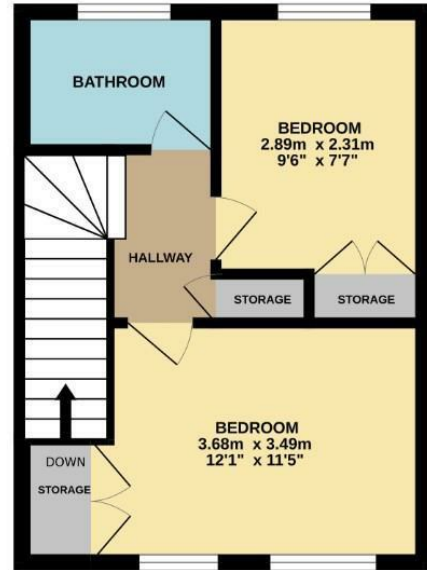

TOTAL FLOOR AREA : 58.3 sq.m. (628 sq.ft.) approx.

Whilst every attempt has been made to ensure the accuracy of the floorplan contained here, measurements of doors, windows, rooms and any other items are approximate and no responsibility is taken for any error, omission or mis-statement. This plan is for illustrative purposes only and should be used as such by any prospective purchaser. The services, systems and appliances shown have not been tested and no guarantee as to their operability or efficiency can be given.
Made with Metropix (c)2009.

